



CUSHING TRANSFORMED



WATKINS FIELD HOUSE

The 30,000 square-foot Watkins Field House, completed in 2016, features three basketball courts, a fitness center, group exercise space, a strength and conditioning room, an athletic training center, locker rooms, and an entry tower that showcases Cushing's proud athletics history.





LEE AND SANBORN HOUSES

Lee House (for girls) and Sanborn House (for boys) opened in the fall of 2017. Each 30,000 square-foot, three-story building features 45 single student bedrooms, four faculty apartments, inviting common area space, and elevators. The dorms are named in honor of longtime faculty members Peggy Lee and Wayne Sanborn.





FISHER-WATKINS DINING COMMONS

The Dining Commons received a complete renovation and 15,800 square-foot addition in 2017-18. The addition features a new kitchen and an expansive servery that includes a large stone pizza oven, centralized salad bar, hot entrees, soups, deli area, and a stir-fry bar. The dining hall was renovated and air-conditioned, as well.







ASHBURNHAM HOUSE

Built in 1915, Ashburnham "Ash" House was remodeled from the ground up in 2017-18. It received 24 reconfigured double-occupancy rooms, two new bathrooms, new stairways, an elevator, a renovated community room, and three refreshed faculty apartments. Ash House is attached to the Fisher-Watkins Dining Commons, and the connector includes three new classroom spaces and a stairway leading to the lower level, which includes the remodeled Joseph Treadwell Student Center, an e-sports lab, mailroom, and the campus store. Welcoming communal outdoor spaces surrounding Ash House and the Dining Commons feature patios, walkways, landscaping, and seating.



IORIO ARENA RENOVATION

Built in 1995, the Theodore Iorio Arena benefitted from several upgrades in 2017: a new arena floor, lighting, rubber flooring, boards, glass, team benches, renovated locker rooms, and more.





QUIMBY FIELD RESURFACING

Dedicated in 1961 to former Headmaster Clarence Quimby, this field was first made over with a turf surface and lights in 2002. In 2017, the field received a fresh turf surface and continues to be a fast, competitive field for our soccer, football, field hockey, and lacrosse programs.





NEW DORMITORY

Construction has begun on a new dormitory which replaces the now-demolished Cooke Hall, adjacent to Drew Common and overlooking Quimby Field. The new dorm will house 60 students in 30 double rooms, along with four faculty apartments. This project continues Cushing's progress on our multi-year facilities renewal and supports the Academy's mission as an unparalleled residential community.

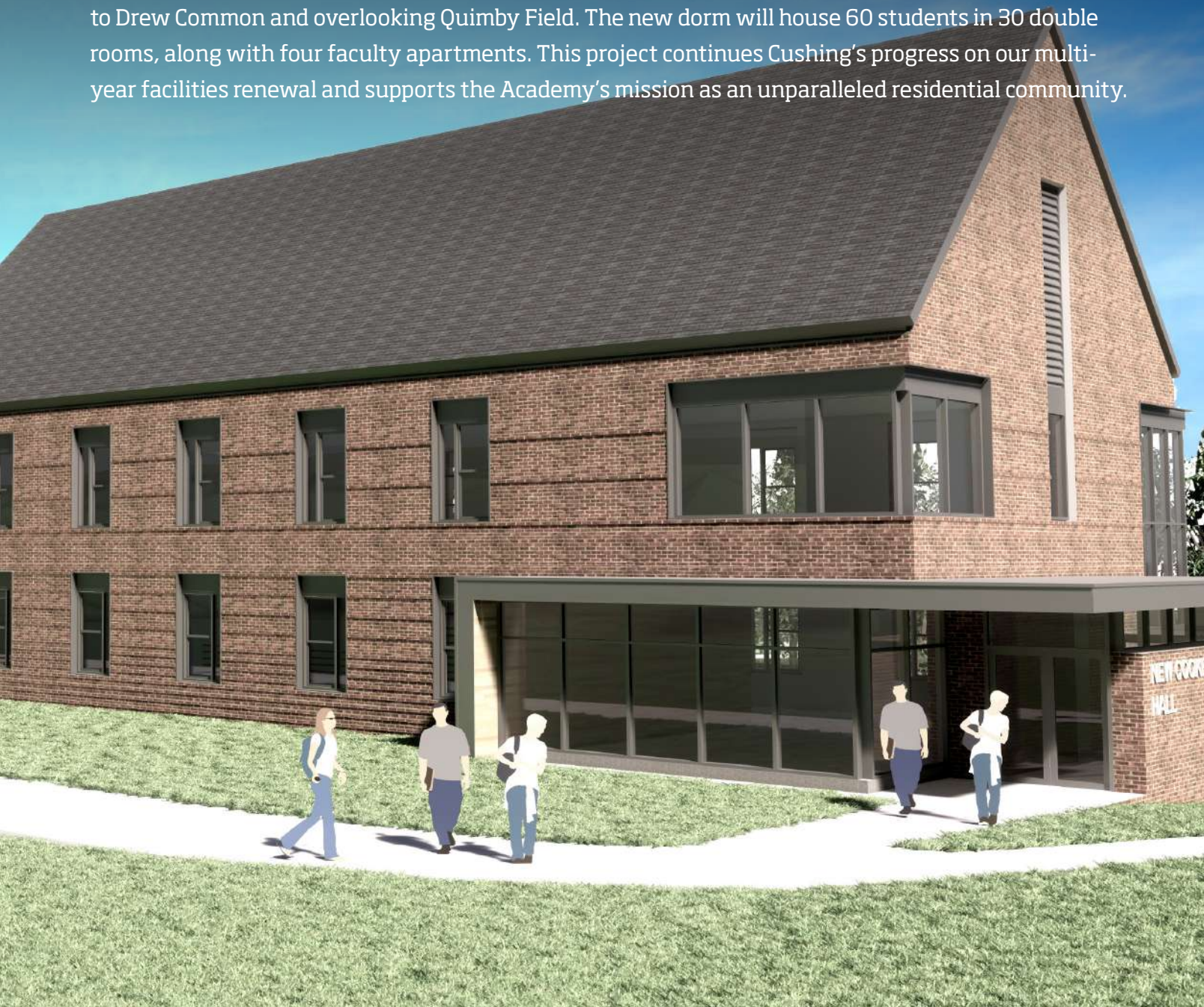



**Building our future
on the foundation of the past.**

**Be part of the new
Cushing Academy.**







CUSHING ACADEMY

39 School Street
Ashburnham, MA 01430

978.827.7300
admissions@cushing.org
www.cushing.org

WWW.CUSHING.ORG

-  facebook.com/cushingacademyfans
-  instagram.com/cushingacademy
-  youtube.com/cushingacademy
-  twitter.com/cushingacademy